

3" SCHOOL ROCKET

DIAMETER

PAYLOAD SECTION INSTRUCTIONS

TOOLS REQUIRED: Scissors, Pliers, Pencil, Yellow Glue.

ASSEMBLY INSTRUCTIONS:

STEP 1. Mark the 1" coupler segment with two vertical lines 5/16" from each other. Cut out the 5/16" wide segment using scissors.

STEP 2: Using pliers on the inside nut, tighten the screw eye in the bulkhead. Slide the bulkhead into the end of the 6" long coupler until it is about 1 1/2" from the end of the tube. **Do not glue in place yet.**

STEP 3: Glue the 1" coupler in the end of the 6" coupler, even with the end of the long coupler. Let dry.

STEP 4: Slide the bulkhead/screw eye back down until it butts up against the glued in coupler. Apply a glue fillet around the inside coupler/bulkhead joint. With a pencil, mark the long coupler at the 3" halfway mark.

STEP 5: Apply glue inside the end of the large payload tube. Slide the coupler/bulkhead assembly into the glued tube with a steady movement without stopping. Slide up to the 3" mark on the coupler tube. Assembly is complete. When adding this payload bay to the 3" School Rocket, the Center of Pressure (CP) moves to 9.4" from rear edge of the body tube.

KIT PARTS

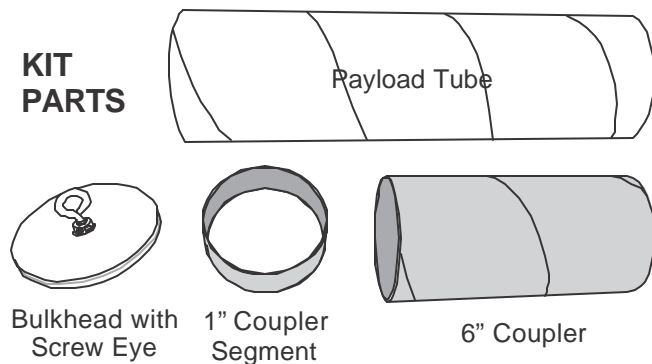

STEP 1

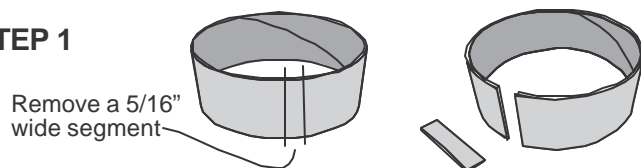

STEP 2

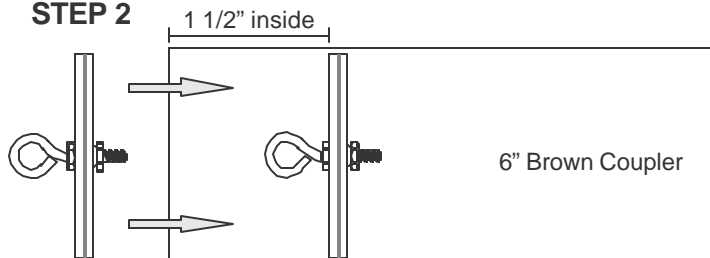

STEP 3

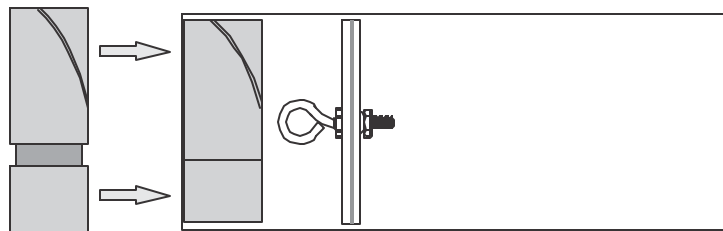

STEP 4

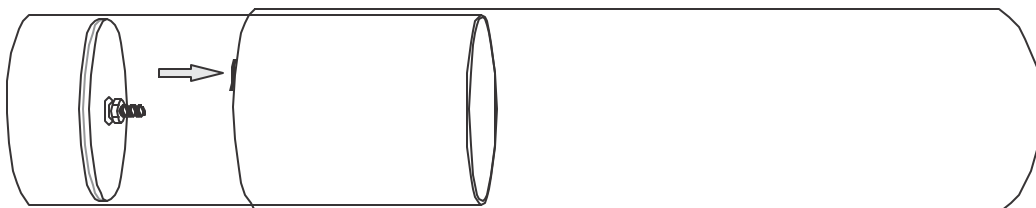
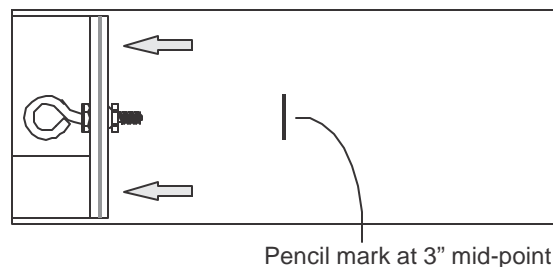

Another Quality Kit from:



Mercury Engineering Co.
3900 S. Winchester
Pahrump, NV 89048
775-537-6232