

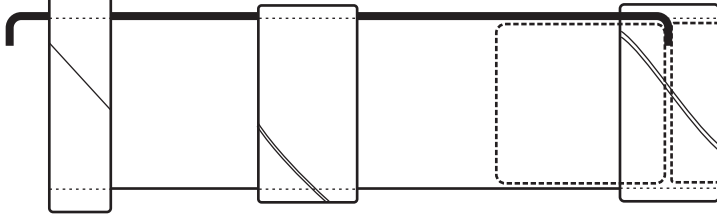

Balsa Machining Service
3900 Winchester Ave.
Pahrump, NV 89048

24mm to 29mm MOTOR ADAPTER



Parts List:

- 1 3.75" long 24mm Tube
- 2 0.5" long 24 to 29mm Centering Rings
- 1 0.25" long 24 to 29mm Centering Ring
- 1 29mm Thrust Ring
- 1 24mm Thrust Ring
- 1 3.75" Motor Hook
- 1 2.75" to 3.75" Motor Spacer
- 1 Rubber Band Assembly Aid

Additional supplies you'll need to complete this kit:
Ruler, Pencil, Hobby Knife, Wood Glue

STEP 1

Glue the 1/4" tall brown centering ring into the slightly wider 1/4" white ring. Let dry.

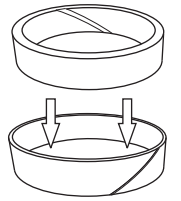

STEP 2

Cut a 1/8" wide notch through the ring using a hobby knife.

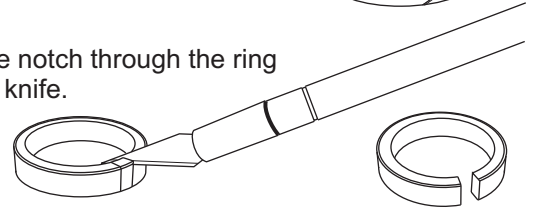

STEP 3

Using the tip of your knife blade, lift and peel a layer from the inside of the two 1/2" tall centering rings until they slide over the 2 3/4" long motor tube.



STEP 4

Mark the motor tube at 1 1/4" from the rear and 1/4" from the top.

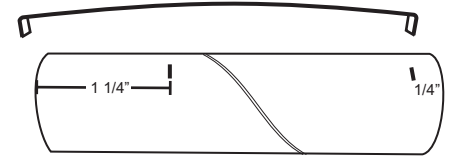

Cut a 1/8" wide notch at the 1/4" mark for the top bend of the engine hook.

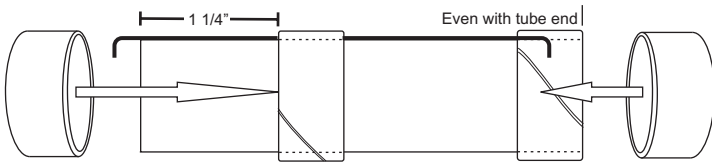

STEP 5

Set the upper bend of the engine hook into the notch. Slide the lower 1/2" wide centering ring over the low end up to the 1 1/4" mark. Glue in place. Glue the upper 1/2" wide centering ring over the top of the tube, over the engine hook and even with the top of the tube end.

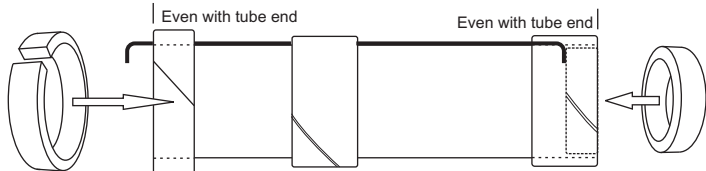

STEP 6

Glue the notched ring over the low end of the engine mount, even with the end of the tube. Center the notched ring over the engine hook. Use the rubber band to hold the ring down as the glue dries.

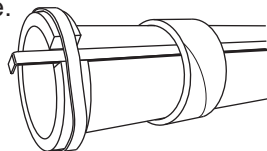

Glue the 24mm engine block into the top end.

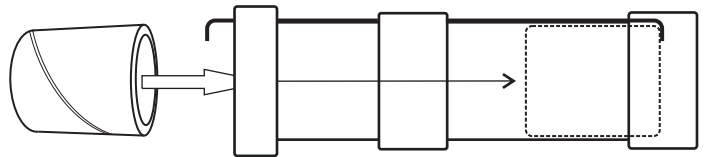

STEP 7

When using a 2 3/4" long engine -
Raise the end of the engine hook. Slide in the 1" long motor spacer inside and all the way forward. Do not glue in the spacer.



Balsa Machining Service
3900 Winchester Ave.
Pahrump, NV 89048

Visit our website:
www.balsamachining.com